

BULLET R1

Quick Start Guide

Unboxing your Roaster

What's in the box
And where does it go?

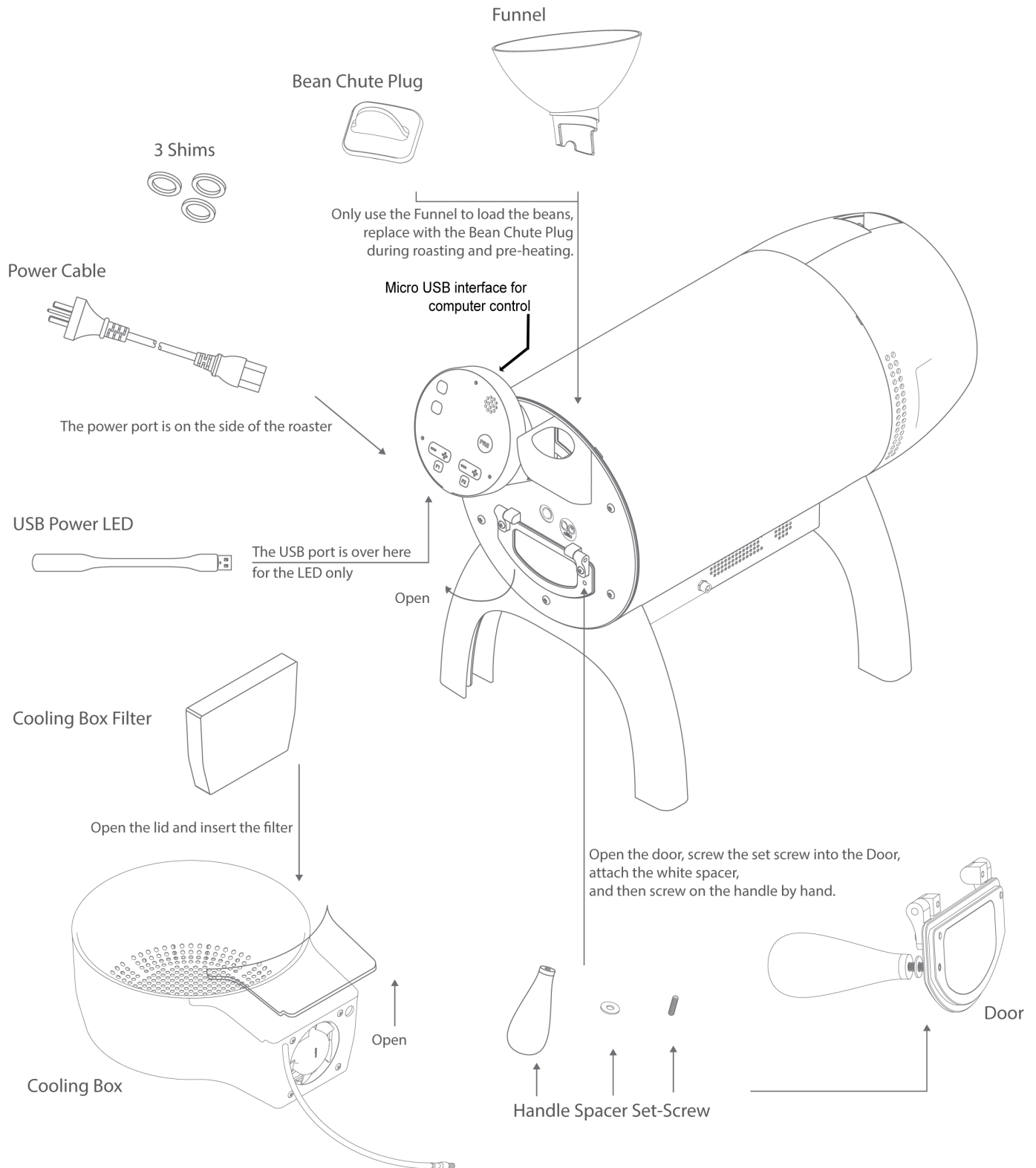

Getting Ready

Place your roaster on a flat, level surface, away from any flammable objects!

The drum is pushed forward into the correct position by a spring in the back. Sometimes during shipping, the drum may lock itself in the back position. To ensure that the drum is in the correct position, reach inside the drum with your hand and try to pull the drum forward (toward you).

Now is the perfect time to read our (short!) manual online, connect the roaster to your computer, and then update the software. Your coffee will thank you.

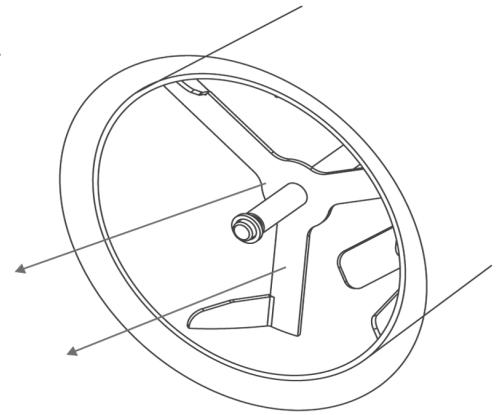

Seasoning the Drum

The drum will need to be properly seasoned with at least five "pre-roasts."
(Please note that the coffee roasted while seasoning the drum is not meant for consumption, so use cheap beans!)

Pre-heat the roaster to 160°C (320°F) before loading in the beans, use D6 + F2 during seasoning.
Take each roast past second crack (consult the manual if you do not know what this means) before discarding.

Please be sure to also discard the chaff after each roast. Directions for removing the chaff collector are below.

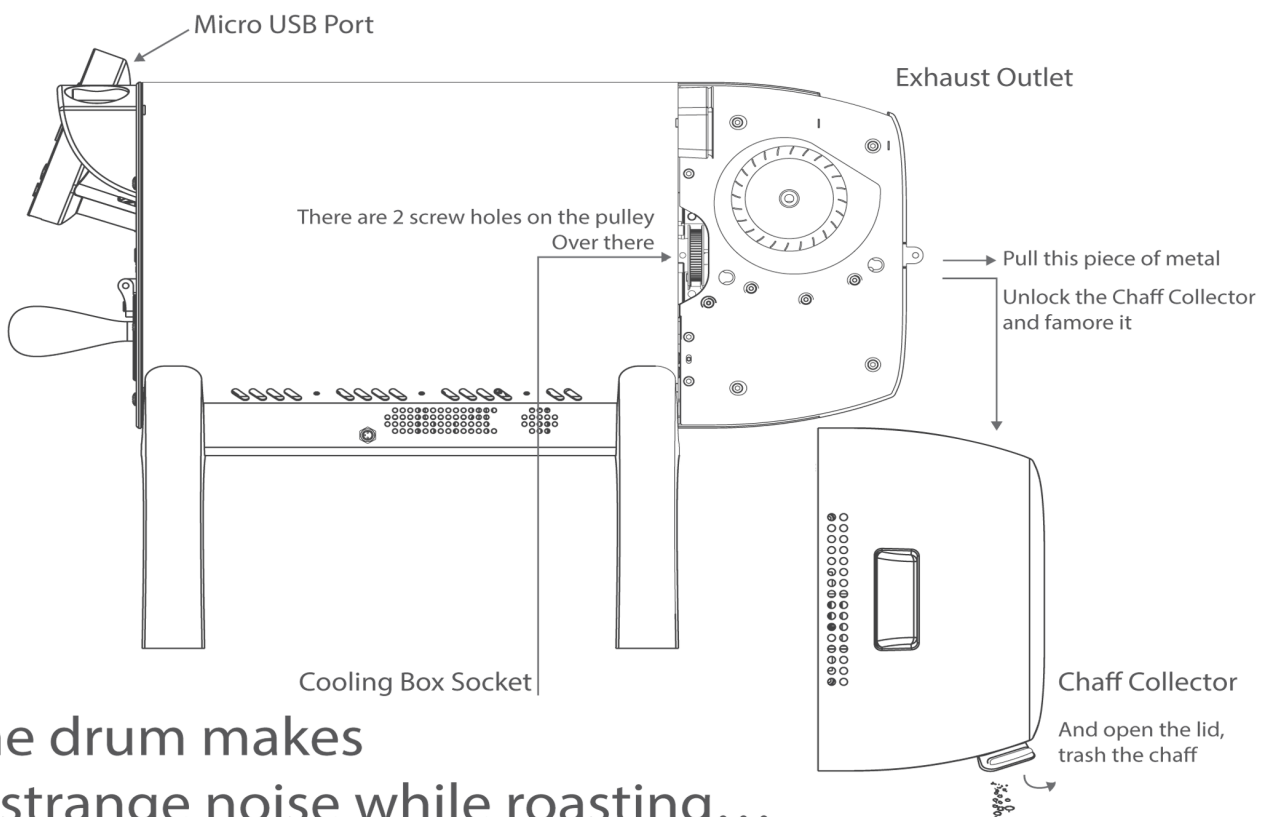

If the drum makes a strange noise while roasting...

A grinding sound indicates that the drum may have become dislodged during shipping. Make sure the gap between the pulley and the housing is approximately 1 mm. You can adjust the gap by loosening the two screws on the pulley and pulling the drum into place before refastening.

If you hear an occasional bumping sound, do not worry. This is normal and will not affect the quality of your roasts.

Please read and follow the manual before contacting us!
Please do not disassemble roaster without contacting us!

phone (+886) 2 2508 0602 or email: support@aillio.com